

A			
	新版图	/	2012.05.23

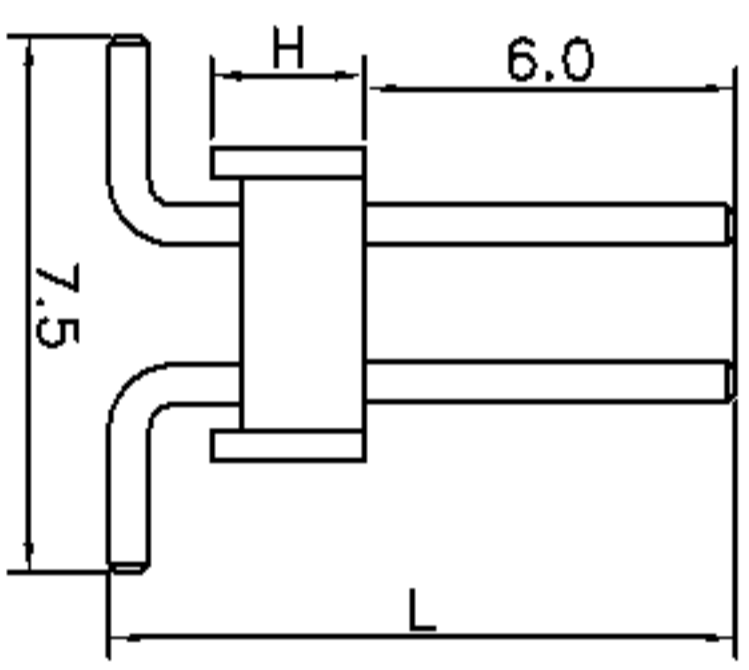

H、L的尺寸  
可依客户要求订做

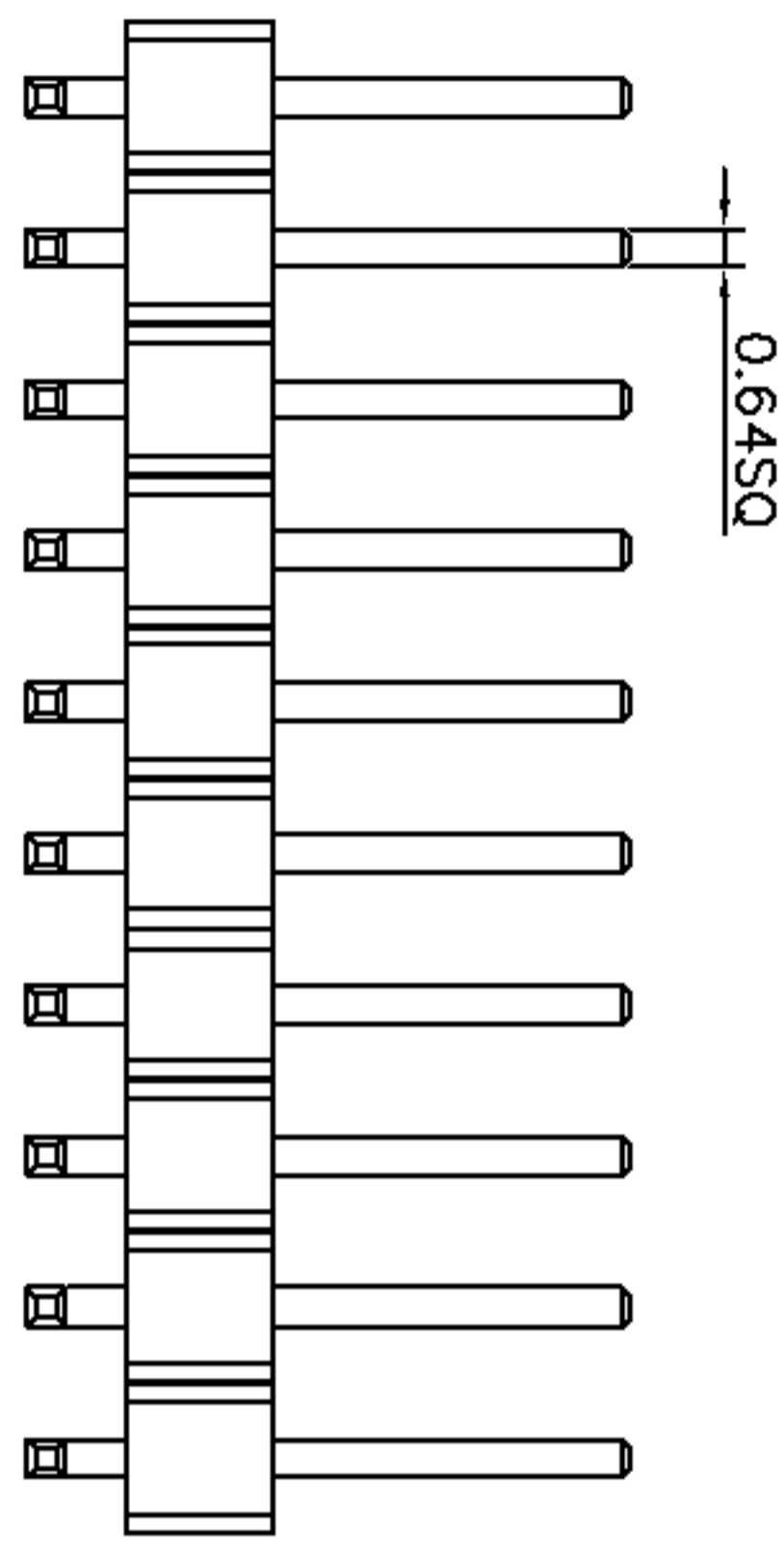
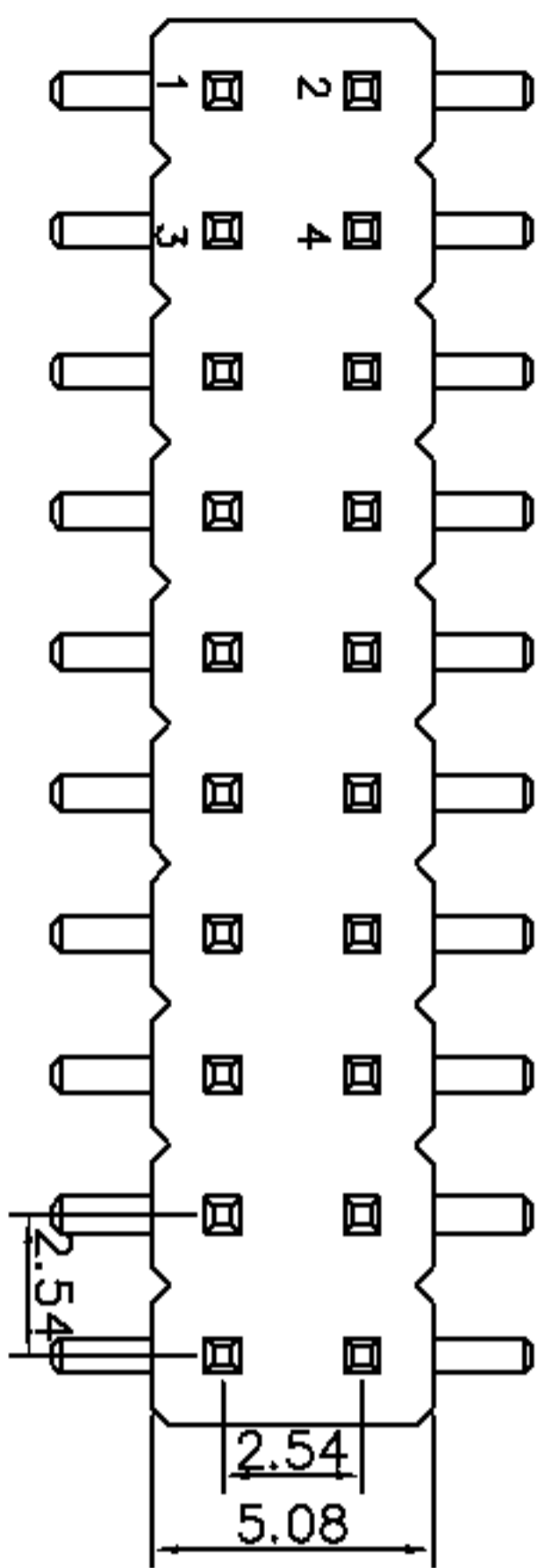
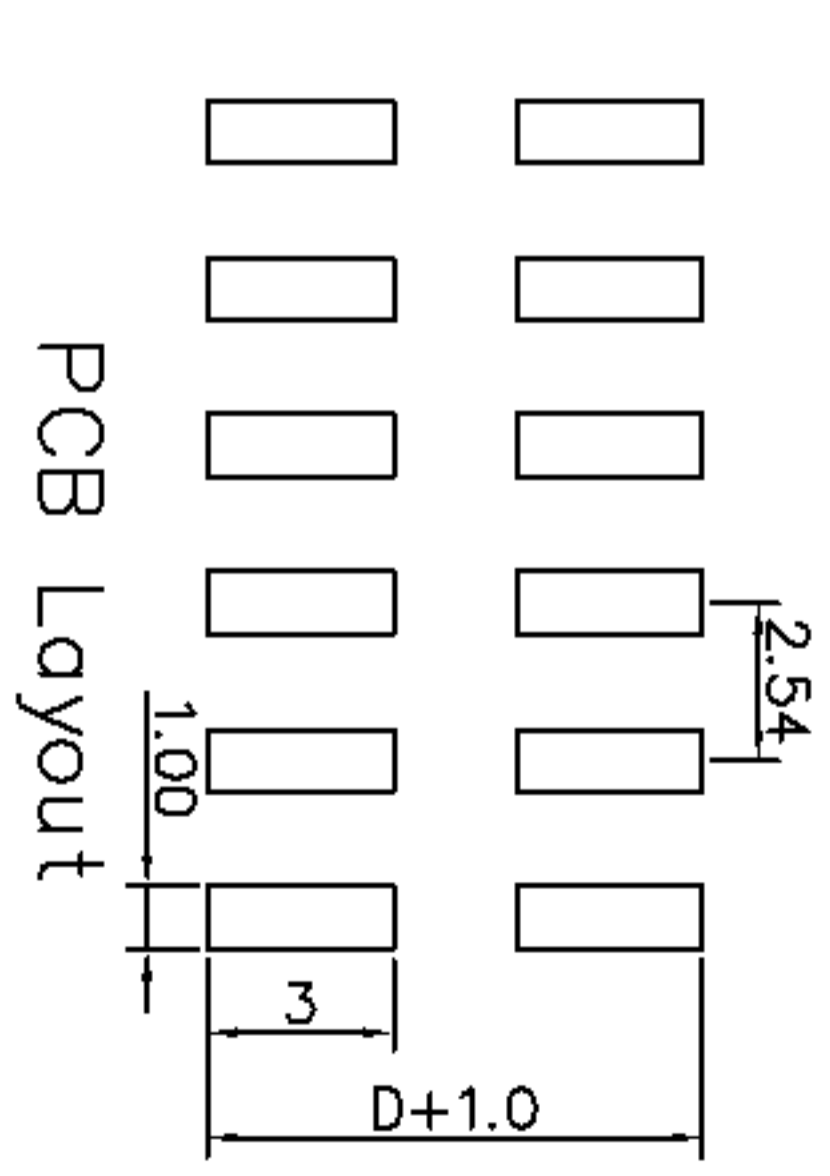

PCB Layout

Technical Data:

Material:  
Contact Material:Brass  
Insulator Material:PBT+30%GF  
Electrical:  
Current rating:3Amps/Contact max.  
Contact resistance:<=20mohms/Contact  
Insulation resistance:>=1000Mohms at V=100V  
Withstanding Voltage:550V AC/Minute  
Mechanical:  
Operating Temperature:Gold plated :-55° C~105° C  
Tin plated :-40° C~105° C  
Soldering Temperature:260° C 10s Max.

1101-254M12XX-H-L  
2.54PIN距单塑胶双排SMT排针系列  
塑高  
总高  
每排PIN数

TOLERANCE		ANGLE	
TOL	ON	ANGLE	
.XXX =	0.05		
.XX =	0.15	1°	
X -	0.20	2°	
X. =	0.30		

DRAWN	DATE	 武汉宇恒电子有限公司 WUHAN YUHENG ELECTRONIC CO., LTD
YSH	2012.05.23	
CHECKED	DATE	TITLE:
		排针系列-2.54 PIN距-双排-单塑形贴片
CLIENT APPROVED	DATE	RFQ NO
		CLIENT P/N
		UNIT: mm
		SCALE: free
		FILE NO.: YH20120529A006