

REV.	NOTES	DATE
A	RELEASED	2006/03/06
B	尺寸2.99變更爲2.54，尺寸 ϕ 2.1變更爲M2.2	2006/04/25

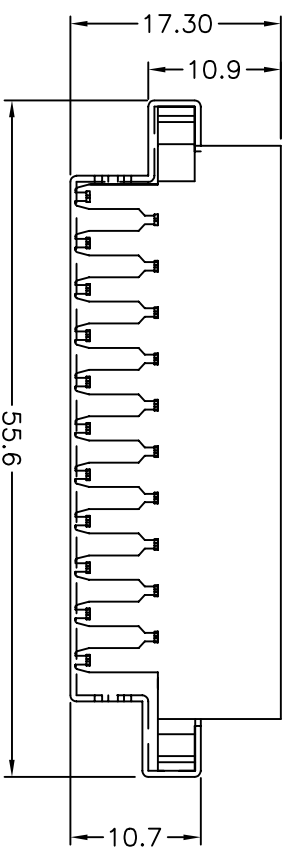

RECOMMEND P.C.BOARD LAYOUT

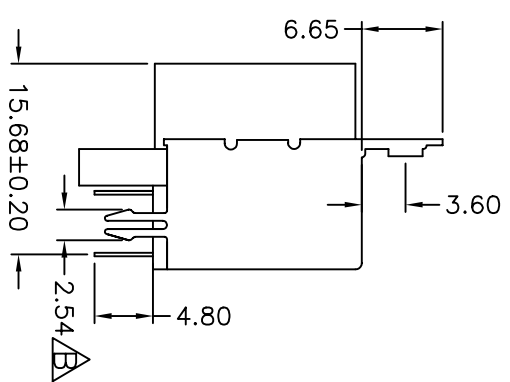
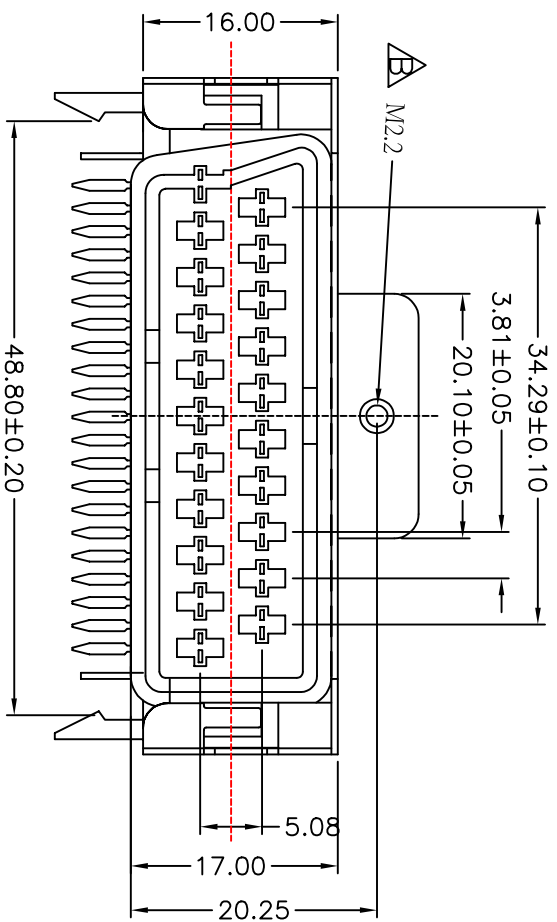
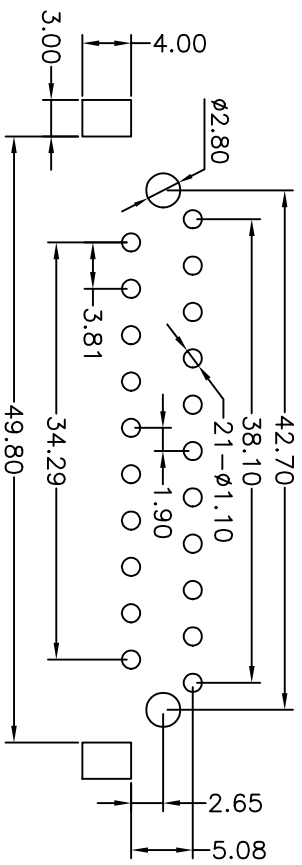

- NOTES:
1. MATERIALS
 - 1.1 Insulator: Pc
 - 1.2 Contact: Brass 0.3T
 - 1.3 Metal sheel: SPCC 0.5T
 - 1.4 Contact Plating: TIN Plated
 2. SPECIFICATIONS
 - 2.1 Current Rating: 3.0Amp
 - 2.2 Dielectric Strength: 1000V AC for one minute
 - 2.3 Insulator Resistance: 1000M Ohms Min.(at 500V DC)
 - 2.4 Operation Temperature: -55°C to +105°C

DIMENSIONS TOLERANCE		繪圖 (DRAW)		圖名 (NAME)	
METRIC		單位 (UNITS)		90度母座有柱有孔錫 PC加鐵殼(無凸) 無毒	
0 = ±.3		數量 (QTY)	mm	料號 (PART NUMBER)	ASC+0350-40C2
.00 = ±.15		材料 (MTR'L)	N/A	圖號 (DRAW NUMBER)	RASC035040C2
.0000 = ±.XXX		處理 (FINISH)	SEE NOTE	圖檔 (FILE NAME .DWG)	E:GCT/A/SC/03
ANG. = ±2°		核准 (APP'D)	SEE NOTE	比例 (SCALE)	1/1
				圖紙 (S/DWG)	A4
				頁次 (SHEET)	1
				版次 (REV.)	B