

P.C.B LAYOUT (15Pins)

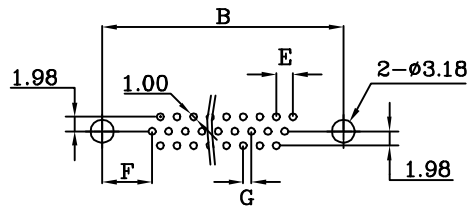

P.C.B LAYOUT (26,44,62Pins)

MATERIALS AND FINISH

SHELL : STEEL MATERIAL, NICKEL FINISHED
 DIMPLES ON PLUG ONLY
 INSULATOR : PBT THERMOPLASTIC, 30% GLASS
 FILLED, UL 94V-0 RATED, BLACK COLOR
 CONTACT MATERIAL: BRASS
 CONTACT FINISH : SELECTIVE GOLD FLASH
 GROUNDING BRACKET : BRASS MATERIAL, TIN FINISHED
 RIVETED INSERT : BRASS MATERIAL , NICKEL FINISHED

ELECTRICAL CHARACTERISTICS

CONTACT CURRENT RATING : 5.0 AMPS
 CONTACT RESISTANCE : 30 MILLIOHMS MAX.
 DIELECTRIC WITHSTANDING VOLTAGE : 1000 V AC MIN.
 INSULATION RESISTANCE : 5000 MEGAOHMS MIN.
 TEMPERATURE RATING : -55°C ~ +105°C

Series No
 No of Contacts
 15: 15 Pins
 26: 26 Pins
 44: 44 Pins
 62: 62 Pins

Contact Type
 1: Plug, Brass
 2: Socket, Brass

Contact Plating
 00: Full gold flash
 01: Selective gold flash

1153-0XX-101-000

Options
 00: With 0.120" diameter holes
 01: With #4-40 Threaded Rivets
 Clinch Nuts on Back Shell
 02: With #4-40 Threaded Rivets
 Boardlocks(Height=6.0mm)
 10: With #4-40 Threaded Rivets
 Clinch Nuts on Front Shell
 12: With #4-40 Threaded Rivets
 Boardlocks(Height=6.0mm) &
 Jack Screws assembled

Insulator
 0: Black
 1: White

POSITION	E	F	G
15M/F	2.29	7.04	1.145
26M/F	2.29	6.88	1.145
44M/F	2.29	6.88	1.145
62M/F	2.41	7.00	1.205

No. of Contact	A ±0.25 ±.010	B ±0.13 ±.005	C ±0.38 ±.015	D ±0.25 ±.010
15	16.92 .666	24.99 .984	30.81 1.213	19.28 .759
26	25.25 .994	33.32 1.312	39.14 1.541	27.51 1.083
44	38.96 1.534	47.04 1.852	53.04 2.088	41.28 1.625
62	55.42 2.182	63.50 2.500	69.32 2.729	57.71 2.272

Drawn by	Zhenxing Fu	2004.06.24
Designed by	Zhenxing Fu	2004.06.24
Approved by	Wangjun	2004.06.24
Units:mm(inches)	TORERANCE	Code:000
Ver NO	Revisions	CHK
Rev Date		Rev Date
SHEET 1 OF 1	XX ±0.13	Scale 1:1
	Angles+ \ - 2°	Ver A0

D-Sub Connector, High Density,
 Low Profile, Dip Type, Straight,
 Machined Pin

Part No. 1153-0XX-101-000

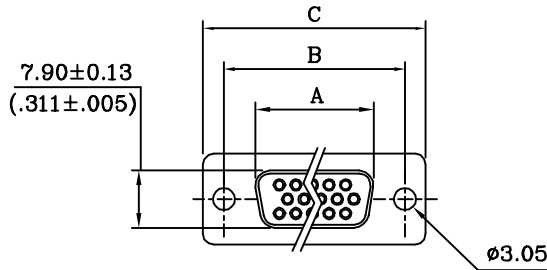

MATERIALS AND FINISH

SHELL : STEEL MATERIAL, NICKEL FINISHED
 DIMPLES ON PLUG ONLY
 INSULATOR : PBT THERMOPLASTIC, 30% GLASS
 FILLED, UL 94V-0 RATED, BLACK COLOR
 CONTACT MATERIAL: BRASS
 CONTACT FINISH : SELECTIVE GOLD FLASH
 GROUNDING BRACKET : BRASS MATERIAL, TIN FINISHED
 RIVETED INSERT : BRASS MATERIAL , NICKEL FINISHED

ELECTRICAL CHARACTERISTICS

CONTACT CURRENT RATING : 5.0 AMPS
 CONTACT RESISTANCE : 30 MILLIOHMS MAX.
 DIELECTRIC WITHSTANDING VOLTAGE : 1000 V AC MIN.
 INSULATION RESISTANCE : 5000 MEGAOHMS MIN.
 TEMPERATURE RATING : -55°C ~ +105°C

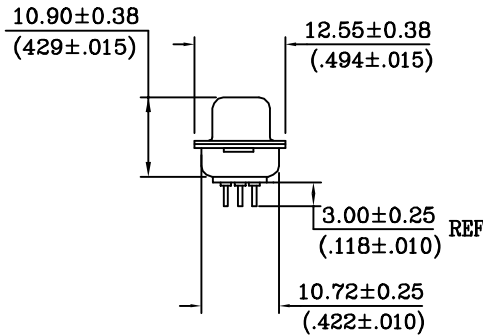
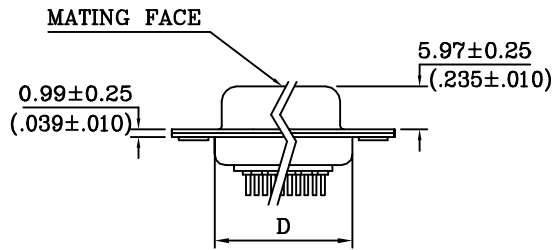

Series No
 No of Contacts
 15: 15 Pins
 26: 26 Pins
 44: 44 Pins
 62: 62 Pins

Contact Type
 1: Plug, Brass
 2: Socket, Brass

Contact Plating
 00: Full gold flash
 01: Selective gold flash

1153-OXX-201-000

Options

- 00: With 0.120" diameter holes
- 01: With #4-40 Threaded Rivets Clinch Nuts on Back Shell
- 02: With #4-40 Threaded Rivets Boardlocks(Height=6.0mm)
- 10: With #4-40 Threaded Rivets Clinch Nuts on Front Shell
- 12: With #4-40 Threaded Rivets Boardlocks(Height=6.0mm) & Jack Screws assembled

Insulator

- 0: Black
- 1: White

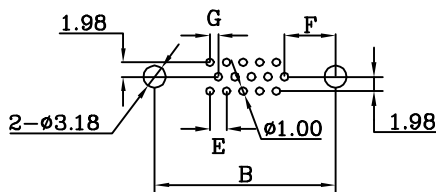

P.C.B LAYOUT (15Pins)

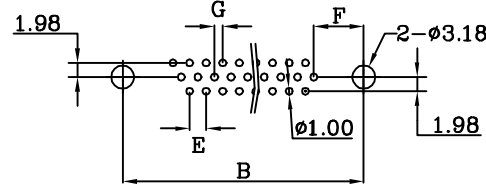

P.C.B LAYOUT(26,44,62Pins)

No. of Contact	A ±0.25 ±.010	B ±0.13 ±.005	C ±0.38 ±.015	D ±0.25 ±.010	E
09	16.33 .643	24.99 .984	30.81 1.213	19.28 .759	11.08 .436
15	24.66 .971	33.32 1.312	39.14 1.541	27.51 1.083	19.39 .763
25	38.38 1.511	47.04 1.852	53.04 2.088	41.28 1.625	33.24 1.310
37	54.84 2.159	63.50 2.500	69.32 2.729	57.71 2.272	49.86 1.963

POSITION	E	F	G
15M/F	2.29	7.04	1.145
26M/F	2.29	6.88	1.145
44M/F	2.29	6.88	1.145
62M/F	2.41	7.00	1.205

				Drawn by	Zhenxing Fu	2004.06.24
				Designed by	Zhenxing Fu	2004.06.24
				Approved by	Wangjun	2004.06.24
				Units:mm(inches)	TORERANCE	Code:000
AO	Drawing	Zhenxing FU	2004.06.24	XX	±0.13	Scale 1:1
Ver NO	Revisions	CHK	Rev Date	SHEET 1 OF 1		Angles+ \- 2°

D-Sub Connector, High Density, Low Profile, Dip Type, Straight, Machined Pin	
Ver AO	Part No. 1153-OXX-201-000

Options:

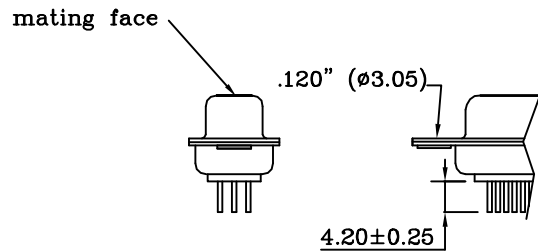

00: With 0.120" diameter holes

Option 00

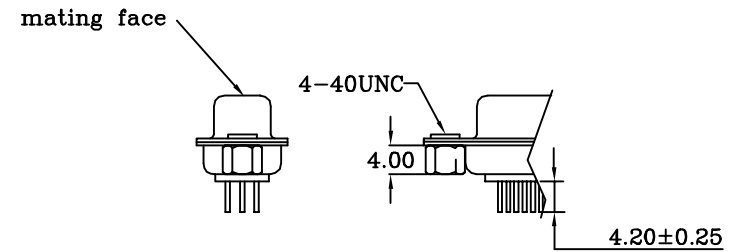

01: With #4-40 Threaded Rivets
Clinch Nuts on Back Shell

Option 01

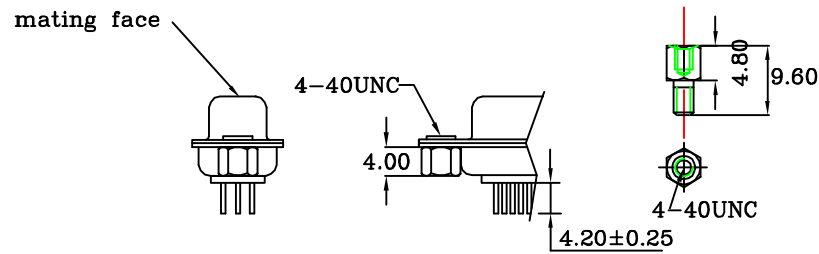

21: With #4-40 Threaded Rivets
Clinch Nuts on Back Shell
& jack screws in bulk

Option 21

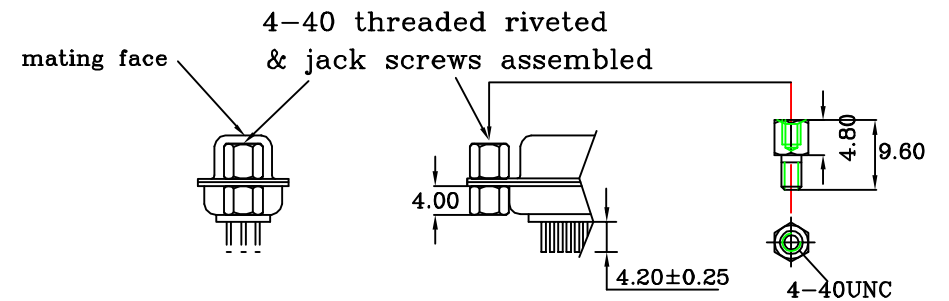

11: With #4-40 Threaded Rivets
Clinch Nuts on Back Shell
& jack screws assembled

Option 11

				Drawn by	Zhenxing Fu	2004.06.24	
				Designed by	Zhenxing Fu	2004.06.24	
				Approved by	Wangjun	2004.06.24	
				TOLERANCE .XX ±0.13	Code:000	D-Sub Connector, High Density, Low Profile, Dip Type, Straight, Machined Pin	
A0	Drawing	Zhenxing FU	2004.06.24		Scale 1:1		
Ver NO	Revisions	CHK	Rev Date	SHEET 1 OF 1	Angles+/-2°		Ver A0

Options:

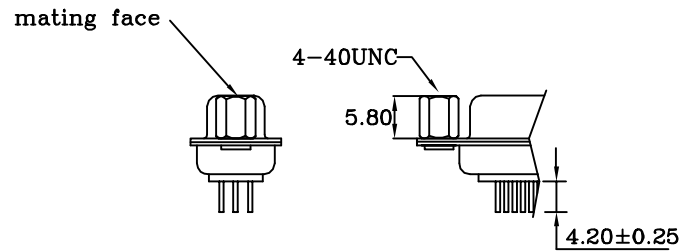

10: With #4-40 Threaded Rivets Clinch Nuts on Front Shell

Option 10

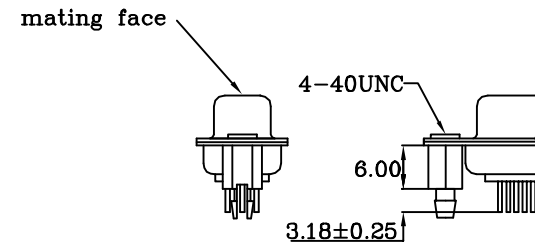

02: With #4-40 threaded rivets BoardLocks(Height=6.0mm)

Option 02

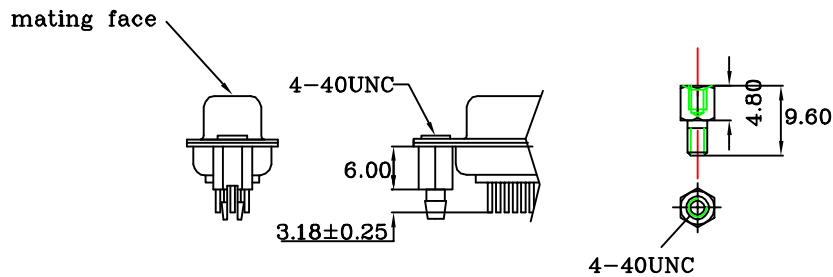

22: With #4-40 Threaded Rivets Boardlocks(Height=6.0mm) & Jack Screws in Bulk

Option 22

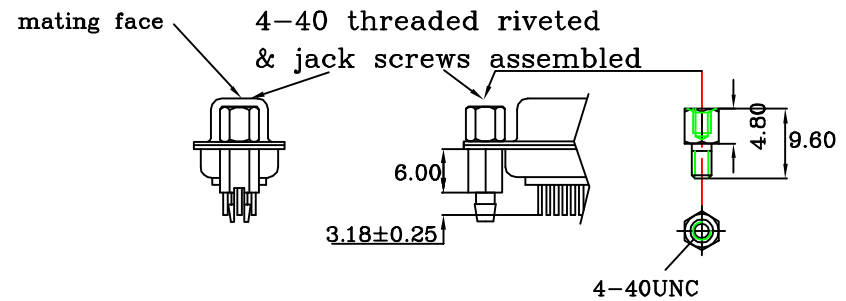

12: With #4-40 Threaded Rivets Boardlocks(Height=6.0mm) & Jack Screws assembled

Option 12

				Drawn by	Zhenxing Fu	2004.06.24	
				Designed by	Zhenxing Fu	2004.06.24	
				Approved by	Wangjun	2004.06.24	
				TOLERANCE .XX ±0.13	Code:000	D-Sub Connector, High Density, Low Profile, Dip Type, Straight, Machined Pin	
A0	Drawing	Zhenxing FU	2004.06.24		Scale 1:1		
Ver NO	Revisions	CHK	Rev Date	SHEET 1 OF 1	Angles+ \ - 2°		Ver A0