

# Pin connectors 1.778mm

Single row

Solder tail

Series: PAA

## PCB pin connectors

Solder tail with reduced pin spacing 1.778mm

### Technical Specs:

Insulator: Black glass filled polyester PPS-GF30-FR  
Flammability: UL 94V-O  
Sleeve: Brass CuZn 36pb3(36000)  
Mating pin Ø: 0.45 mm  
Mechanical life: min 500 cycles  
Rated current: 1 A  
Contact resistance: max 10 mΩ  
Dielectric strength: min 1000V<sub>RMS</sub>



## Ordering information

PAA - NNN1 - A P 1000A

No. of Positions

Pin Plating code

1	Tin150μ"
2	Tin200μ"
3	GF
4	Gold2μ"
5	Gold3μ"
6	Gold10μ"
7	Gold15μ"
S	Special

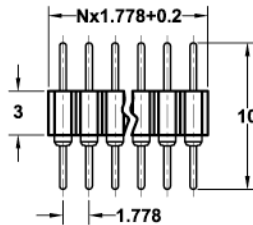
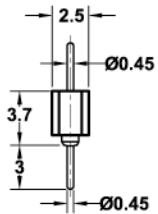

PAA-NNN1-APP1000A

Straight pin connector: single row,  
grid spacing 1.778mm  
Availability from: 2 to 32 contacts  
Standard number of contacts 21 and  
32

# Dual-in-line pin headers 1.778mm

Open frame

Solder tail

Series: PAA

**DIL pin headers with male contacts pluggable into standard female socket contacts**  
**Solder tail with reduced pin spacing 1.778mm**

**Technical Specs:**

Insulator: Black glass filled polyester PBT-GF30-FR  
 Flammability: UL 94V-O  
 Sleeve: Brass CuZn 36pb3(36000)  
 Mating pin Ø: 0.50 mm  
 Mechanical life: min 500 cycles  
 Rated current: 1 A  
 Contact resistance: max 10 mΩ  
 Dielectric strength: min 1000V RMS

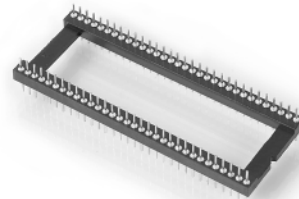

## Ordering information

PAA - NNN X - A P 1000A

No. of Positions	Row spacing code	Pin Plating code
	4 10.16mm	1 Tin150μ"
	6 15.24mm	2 Tin200μ"
	7 19.05mm	3 GF
		4 Gold2μ"
		5 Gold3μ"
		6 Gold10μ"
		7 Gold15μ"
		S Special

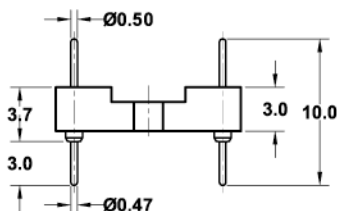
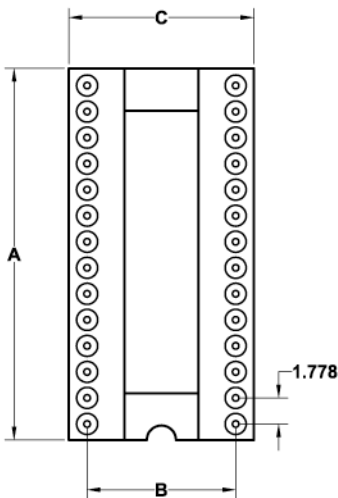

See page 35	No. of Positions	A	B	C	Order Codes
fig. 1	24	21.8	10.16	12.7	PAA-0244-AP1000A
fig. 2	28	25.2	10.16	12.7	PAA-0284-AP1000A
fig. 3	30	27.0	10.16	12.7	PAA-0304-AP1000A
fig. 4	32	28.8	10.16	12.7	PAA-0324-AP1000A
fig. 5	48	43.1	10.16	12.7	PAA-0484-AP1000A
fig. 6	20	18.1	15.24	17.64	PAA-0206-AP1000A
fig. 7	24	21.7	15.24	17.64	PAA-0246-AP1000A
fig. 8	28	25.2	15.24	17.64	PAA-0286-AP1000A
fig. 9	40	35.8	15.24	17.64	PAA-0406-AP1000A
fig. 10	42	37.7	15.24	17.64	PAA-0426-AP1000A
fig. 11	48	43.1	15.24	17.64	PAA-0486-AP1000A
fig. 12	52	46.7	15.24	17.64	PAA-0526-AP1000A
fig. 13	56	50.2	15.24	17.64	PAA-0566-AP1000A
fig. 14	64	57.3	15.24	17.64	PAA-0646-AP1000A
fig. 15	68	60.9	15.24	17.64	PAA-0686-AP1000A
fig. 16	64	57.3	19.05	21.45	PAA-0647-AP1000A