

# Pin connectors 1.27mm

Single row/double row

Surface mount

Series: PED

## Ultraminiature PCB pin connectors, surface mount

### Technical Specs:

Insulator:	Black glass filled polyester PPS-GF30-FR
Flammability:	UL 94V-O
Sleeve:	Brass CuZn 36pb3(36000)
Mating pin Ø:	0.41 mm
Mechanical life:	min 500 cycles
Rated current:	1 A
Contact resistance:	max 10 mΩ
Dielectric strength:	min 1000V <sub>RMS</sub>
Coplanarity SMD terminations:	max 0.1mm(measured on 25 mm long connectors)

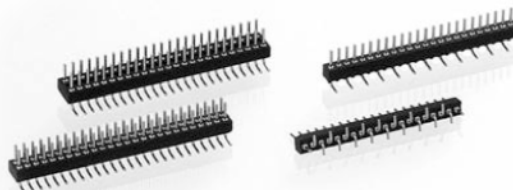

## Ordering information

PED - NNN X - A P 0820A

No. of Positions	Insulator Type code	Pin Plating code
	1 Single row	1 Tin150μ"
	2 Double row	2 Tin200μ"
	3 Triple row	3 GF
		4 Gold2μ"
		5 Gold3μ"
		6 Gold10μ"
		7 Gold15μ"
		S Special

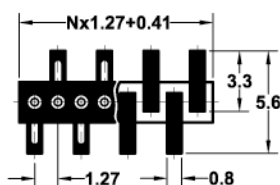
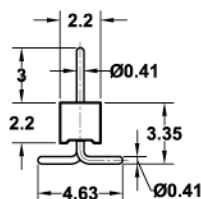

PED-NNN1-AP0820A

SMD pin connector: single row.  
perpendicular mount  
Availability from: 3 to 50 contacts  
Standard number of contacts 25 and 50

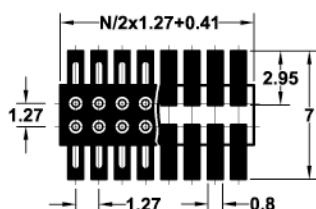
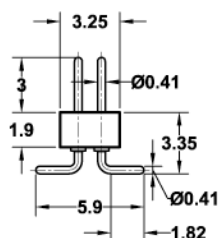

PED-NNN2-AP0820A

SMD pin connector: double row.  
perpendicular mount  
Availability from: 4 to 100 contacts  
Standard number of contacts 50 and 100

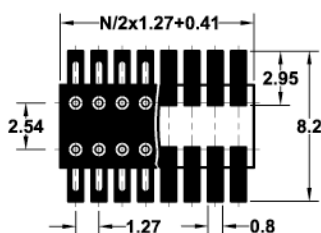
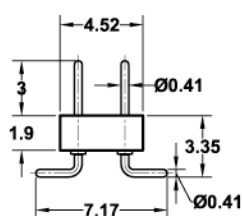

PED-NNN2-BP0820A

SMD pin connector: double row.  
with 2.54 mm row to row distance  
perpendicular mount  
Availability from: 4 to 100 contacts  
Standard number of contacts 100

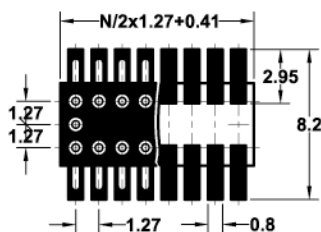
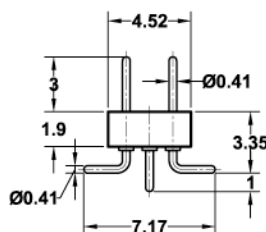

PED-NNN3-AP0820A

SMD pin connector: double row.  
with 2.54 mm row to row distance  
perpendicular mount with 2  
Availability from: 4 to 100 contacts  
Standard number of contacts 100