

VIEW O  
SCALE 2:1

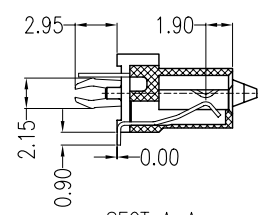

SECT A-A

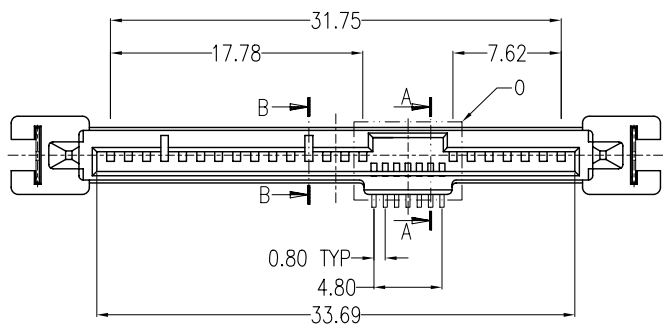
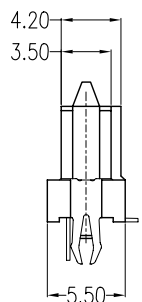
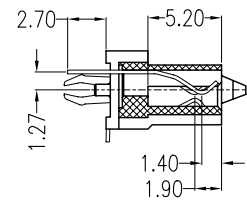
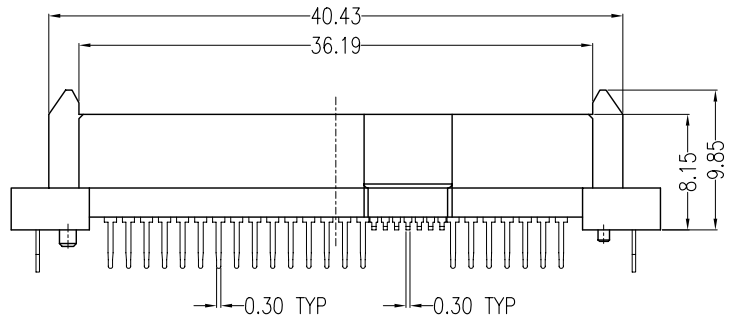

SECT B-B

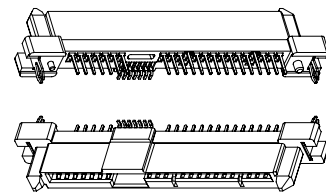
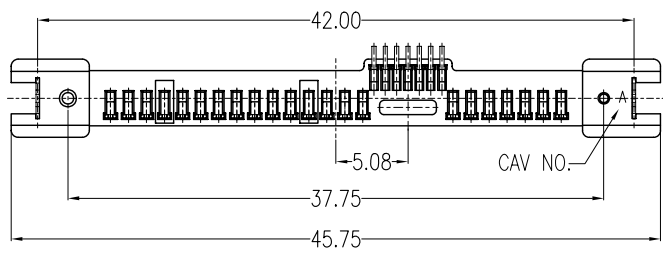

Product 3D Dwg

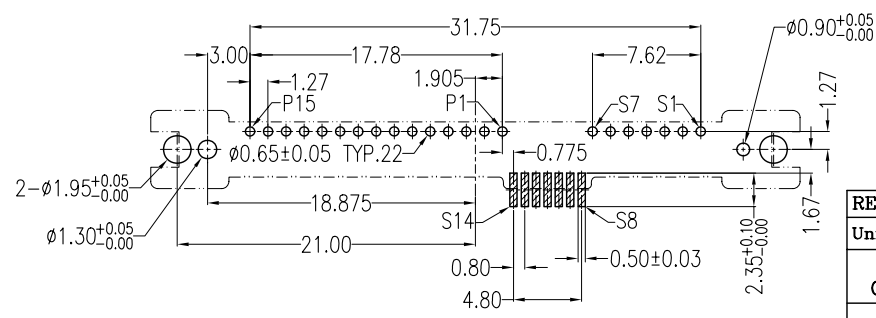

PCB LAYOUT  
TOP VIEW

**NOTES:**

**\*Material**

Housing: LCP, UL 94V-0 rated, Color: Black;  
 Contact: Phosphor Bronze;  
 Plating: Gold plating over Nickel on contact area; Tin plating on solder tail.  
 Harpoon: Phosphor Bronze;  
 Plating: Tin plating over Nickel.

**\*Mechanical**

Insertion Force: 25N max.  
 Withdrawal Force: 5N min.  
 Durability: 500 cycles

**\*Electrical Specification**

Current Rating: 1 Ampere per contact;  
 Contact Resistance: 30 Milliohms max.  
 Insulation Resistance: 1000 megohms min.  
 Dielectric Withstanding Voltage: 500 V AC.

**\*Environmental**

Operating Temperature: 0° C to +55° C

**\*How to order**

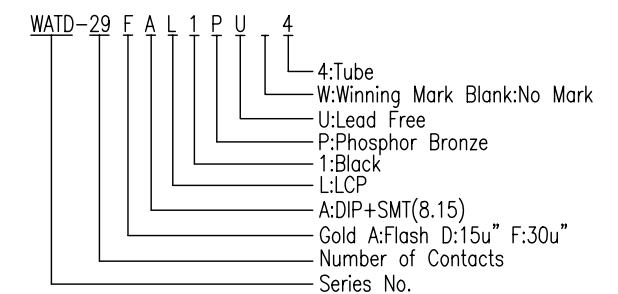

REV		Units		Drawing By		Date	
mm	Scale 1:1	Stacy					
Tolerance Unless Otherwise Specified				Reviewed By		Date	
.X	~ ±0.38	Roger					
.XX	~ ±0.25	Approval By		Date			
.XXX	~ ±0.20	Richard					
Angle	~ ± 3°						
				Date		Title	
				Sheet 1 of 1		SAS 7+15+7P Straight	
				Third Angle Projection		DIP+SMT Female(8.15)	
				Drawing No.		WATD-29PS-AN-N149 REV A	